

**ENGLISH**

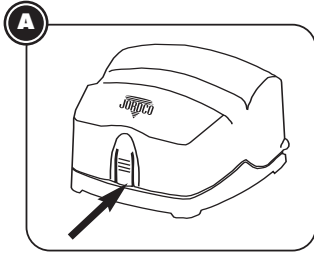

**ENDORING FILECADDY INSTRUCTIONS FOR USE:**



**OPENING ASSEMBLY**

Open the FileCaddy lid by pushing on the locking tab (see figure A). Lift the front of the lid and slide back into the open position. The lid can be removed for cleaning by gently pulling the open lid directly upward from the pivot points on the base.

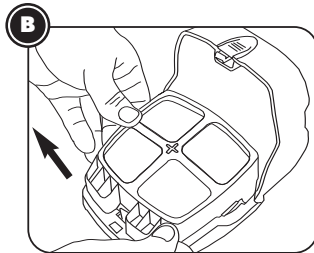

**PLACING FOAM INSERT**

To place a foam insert into the FileCaddy you must first separate the retainer from the base. Apply finger pressure onto the front latch and pull back while lifting and rocking the base to separate the components (see figure B). Once the retainer has been separated, place a foam insert with the small v-notched sides facing forward (see figure C). Insert the cross on the base through the corresponding cross in the center of the foam insert. Push foam insert into place. Gently press down on the retainer until a snap is heard. You can also pull forward on the latch to assist with this operation (see figure D).

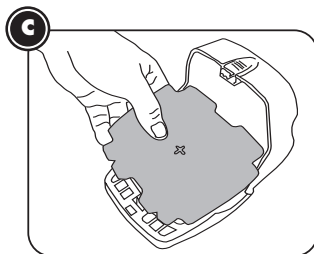

**LOADING FILES**

Load files and optional EMTs (Endoring Marking Tabs) into foam as needed. Return the lid to its locked position by gently sliding the lid forward and pushing down until a snap is heard. The FileCaddy is now ready for processing.

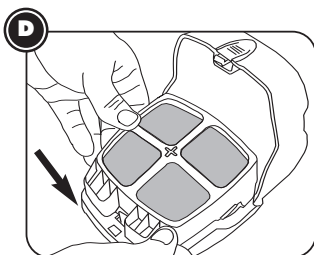

**PROCESSING (AUTOCLAVING)**

Once the files have been loaded and the lid locked, place assembly into the autoclave for processing. Process at a maximum temperature of **275°F (135°C)**. The FileCaddy must remain in autoclave through the entire drying cycle as recommended by the autoclave manufacturer.

**ASSEMBLY CLEANING INSTRUCTIONS**

Some discoloration of the FileCaddy may occur may from reuse of the foam inserts during repetitive autoclaving. Discolorations can be easily removed by soaking the three FileCaddy components in undiluted household bleach. Thoroughly rinse all components with clean water after soaking in bleach.

**OPTIONS AND SUGGESTIONS**

1. Long shank burrs or cotton pellets can be stored in the wells at the front of the FileCaddy.
2. The torpedo shaped base foam dust protector is used to occlude the bottom of the FileCaddy and is seated with gentle finger pressure.

**PROCESSING INSTRUCTIONS:**

FileCaddy Assembly

**Steam Autoclave Only.** See autoclave manufacturer's directions for processing instructions. Do not exceed temperature of **275°F (135°C)**.

Foam Inserts



Steam autoclave only prior to use. **DO NOT REUSE FOAM INSERT.** Autoclaving **will not** remove bioburden left behind from prior usage.

**Warning:** Do not place any components into Surgical Milk or instrument dips prior to autoclaving.



**Jordco, Incorporated**

595 NW 167th Avenue, Beaverton, OR 97006 USA  
 800/752-2812 (within USA), 503/531-3904 (outside USA)  
 503/531-3757 FAX  
 www.jordco.com

**Authorized Representative in the EU**

AR-MED Ltd.  
 Runnymede Malthouse  
 Egham TW20 9BD  
 United Kingdom