

ENGLISH

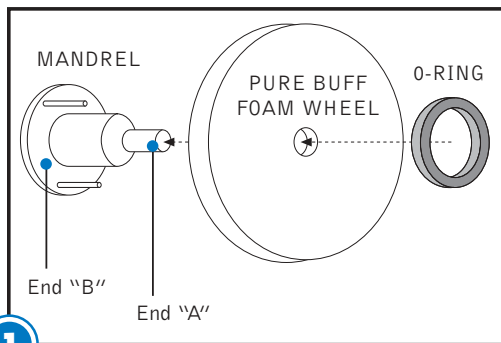

**PURE BUFF INSTRUCTIONS FOR USE:**

**1** Begin by attaching a Pure Buff wheel to the patented mandrel. Pass the mandrel end "A" through the center perforation of the Pure Buff wheel and engage the retention pins as shown in Figure 1. The O-ring must pass over the mandrel end "A" and seat firmly against the wheel. For lathes equipped with a **Quick Chuck\***, insert end "A" into the chuck. For lathes without a Quick Chuck, remove any existing mandrel or tool from the lathe and place end "B" onto the free shaft of the lathe. Refer to Figure 2 for the correct orientation of the mandrels to the lathe. **Only** Pure Buff wheels can be used on the patented Pure Buff mandrel.



**1**

Place Pure Buff onto Mandrel. Secure O-Ring firmly against Pure Buff wheel by placing over Mandrel end "A".

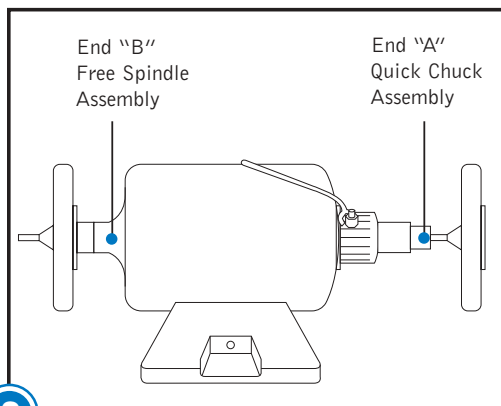

**2**

**2** Begin the initial polishing with a **fine flour** of pumice slurry. Always use a generous amount of the slurry and a moderate amount of pressure to achieve a preliminary polish. To achieve a final high shine, dilute the slurry with some water and use a very light pressure to polish. **HINT:** Prior to polishing, line the lathe pan with aluminum foil to help with an easy clean up and infection control.

**3** To polish confined areas that are often found in lower dentures, split the polishing wheels into two halves. While the wheel is rotating in the lathe, use the flange of the denture to perform the split by pressing the denture flange against the rotating wheel. With the wheel half the original width you can easily maneuver into narrow confines.

**4** After polishing, reduce cross contamination by disposing **only** the used Pure Buff wheel. Remove the mandrel and O-rings and process these items by steam autoclave or chemiclave methods only. Discard the soiled pumice, the Pure Buff wheel and the foil pan liner. Disinfect the lathe and associated surfaces using normal office asepsis procedures.

\*Includes Wells Quick Chuck, Handler Chuck Changer or Jacobs Atlas Chuck #18.



As with any rotary, high speed lathe, safety eyewear is mandatory. Use of splash shield is also highly recommended to help reduce airborne debris.



**The foam wheels are for single use only.** Do not re-sterilize after use. Dispose to prevent cross-contamination of dangerous pathogens or bioburden. The interior of the foam is inaccessible to steam or vapor.



**Jordco, Incorporated**  
 595 NW 167th Avenue, Beaverton, OR 97006 USA  
 800/752-2812 (within USA), 503/531-3904 (outside USA)  
 503/531-3757 FAX  
 www.jordco.com

**Authorized Representative in the EU**  
 AR-MED Ltd.  
 Runnymede Malthouse  
 Egham TW20 9BD  
 United Kingdom